



## 4 Thamesmead Villas Walton Lane

Shepperton, TW17 8LL

**Asking price £650,000**



Overlooking fields to the front is this unique home that has a detached annexe with its own garage and a detached pool house.

The main property is an end of terrace home that offers three bedrooms, two bathrooms and two reception rooms. The property has off street parking on the driveway to the front and step out of the home at the rear to low maintenance garden and access to the pool house.

Beyond the pool house is the annexe, which has a large open plan living area and kitchen, three piece bathroom suite and double bedroom. The annexe has its own garden and access from its garage. This is ideal for the extended family.





# Floor Plan

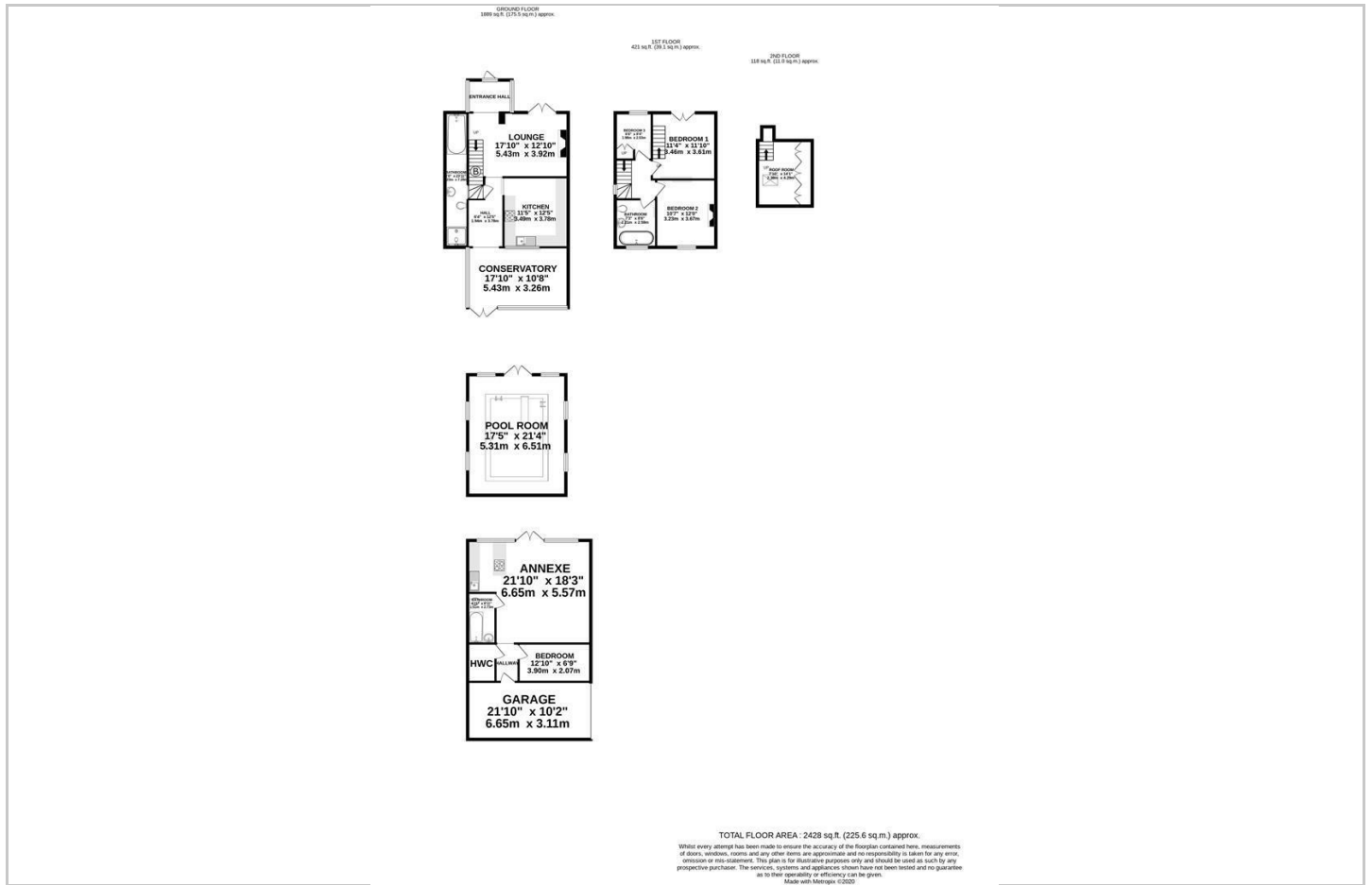

# Area Map



# Viewing

Please contact our Shepperton - Sales Office on 01932232927 if you wish to arrange a viewing appointment for this property or require further information.

These particulars, whilst believed to be accurate are set out as a general outline only for guidance and do not constitute any part of an offer or contract. Intending purchasers should not rely on them as statements of representation of fact, but must satisfy themselves by inspection or otherwise as to their accuracy. No person in this firm's employment has the authority to make or give any representation or warranty in respect of the property.

# Energy Efficiency Graph

